

I .Required parts

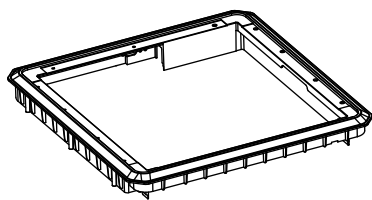

05.201.0242

Upper frame plastic shell-B

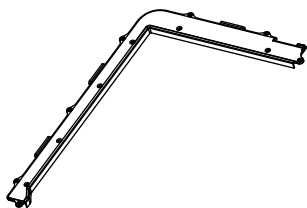

05.201.0243

Upper frame plastic bottom shell-B



09.206.0028

Thin Head Hex Socket
Self-Tapping M3*6
12PCS



09.202.0045

Button Head Hex Socket
M3*6
6PCS (spare)

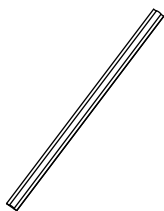

04.210.0029

Lighting strip

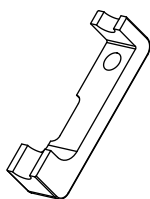

05.201.0244

Light strip pressure block
4PCS



10.202.0236

Light strip adapter cable

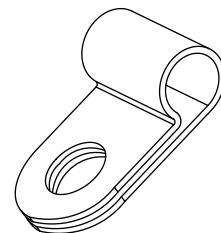

05.209.0053

R-type wire clamp



12.204.0075B

Anti collision cotton
on the side of the drag chain



12.204.0059

EVA foam-H10



12.204.0064

EVA foam-17.5
3PCS

II .Replacement steps

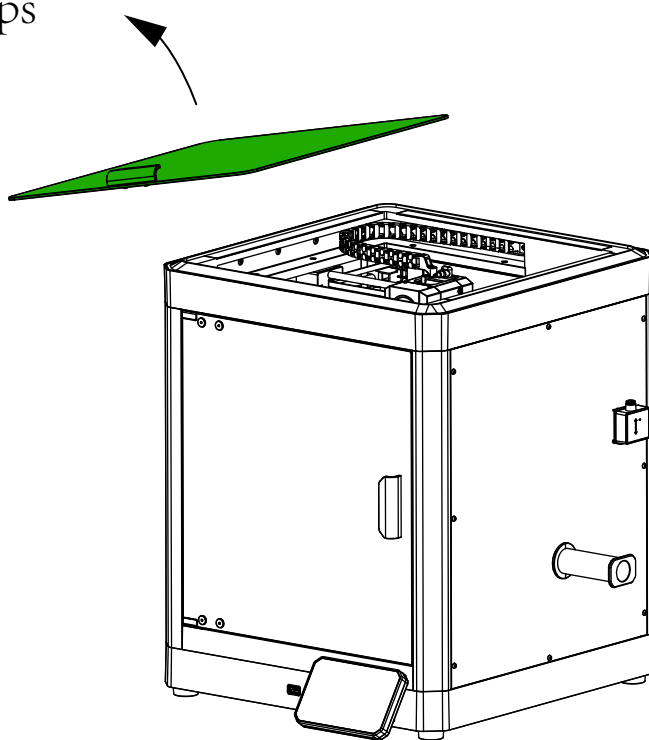

1.Please remove the glass cover component first and disconnect the machine power supply

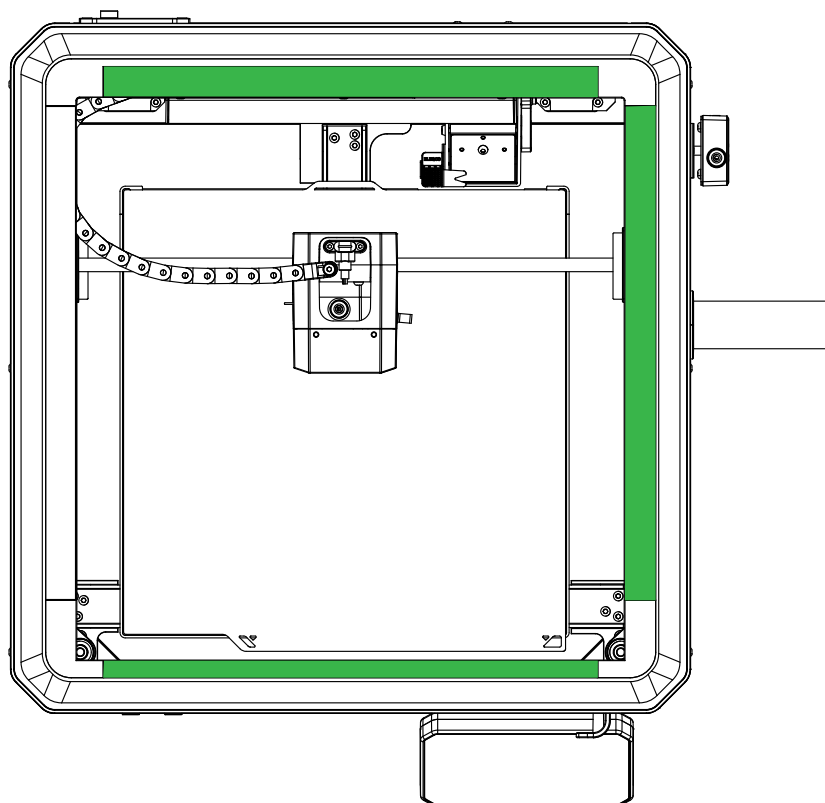

2. Please tear off the EVA foam

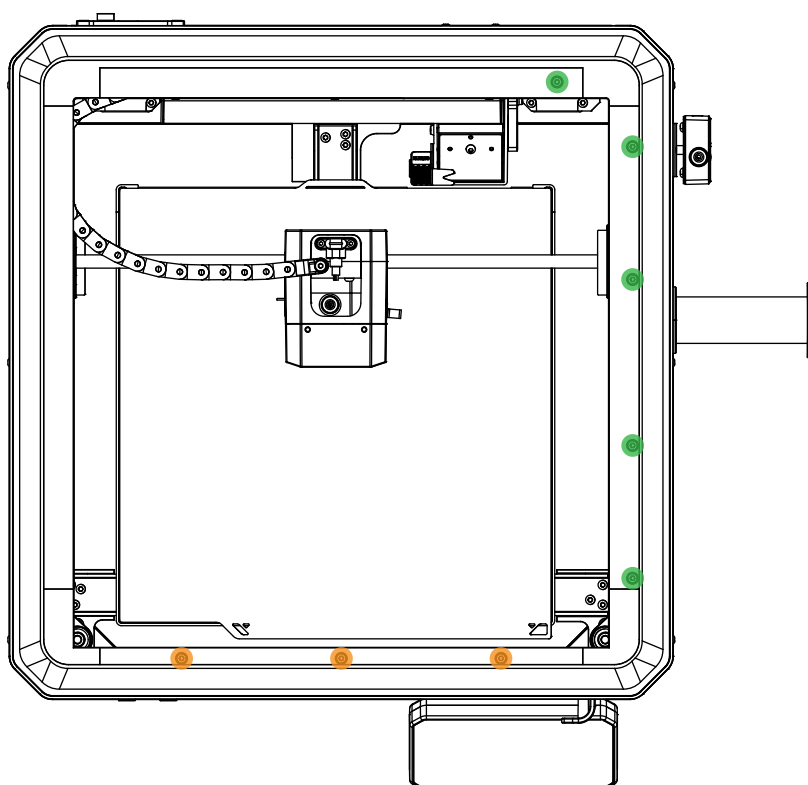

● M3X40 5PCS

● M3X25 3PCS

3. Please unscrew the screws that secure the plastic casing of the old upper frame

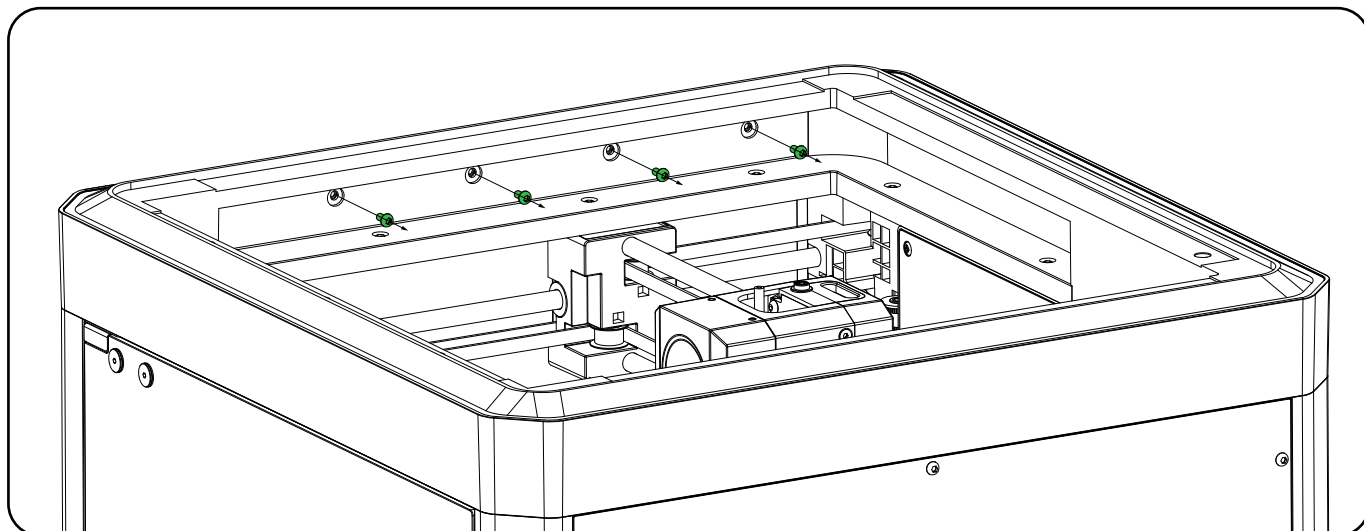

4. Please unscrew the four screws on the left side of the machine that secure the old plastic casing of the upper frame (M3*6)

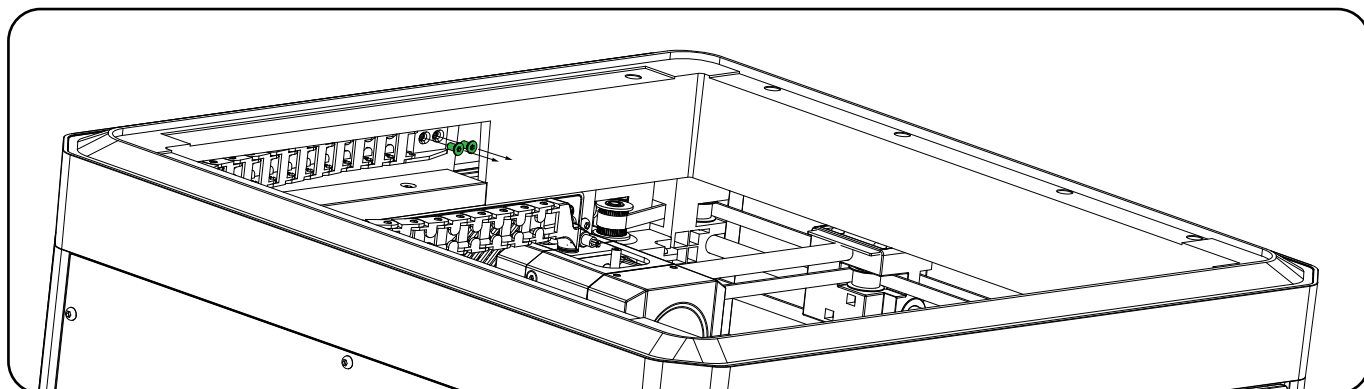

5. Please unscrew the two screws that secure the base of the drag chain(countersunk M3*6)

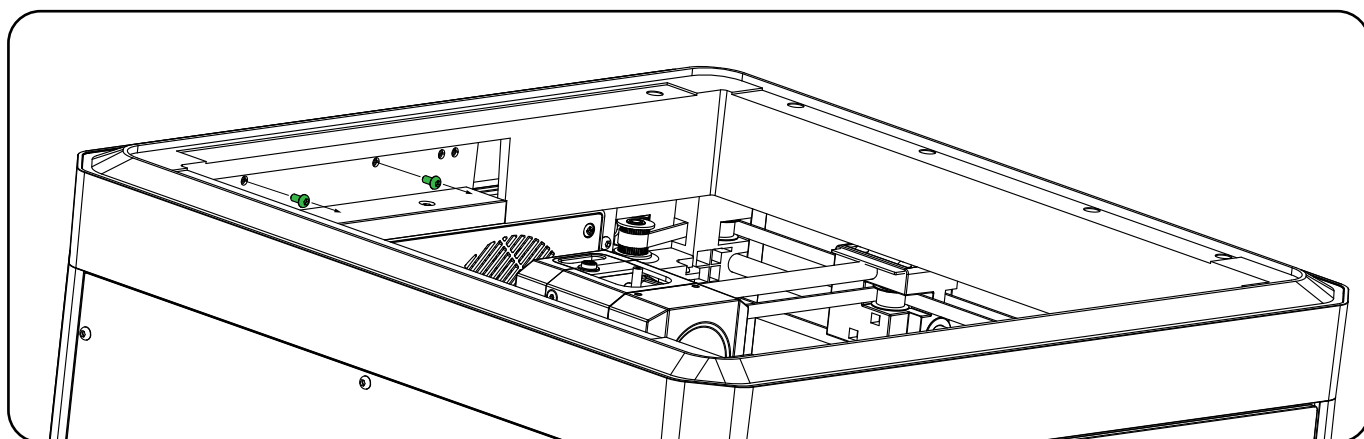

6. Please unscrew the two screws that secure the plastic casing of the frame at the rear of the machine(M3*6)

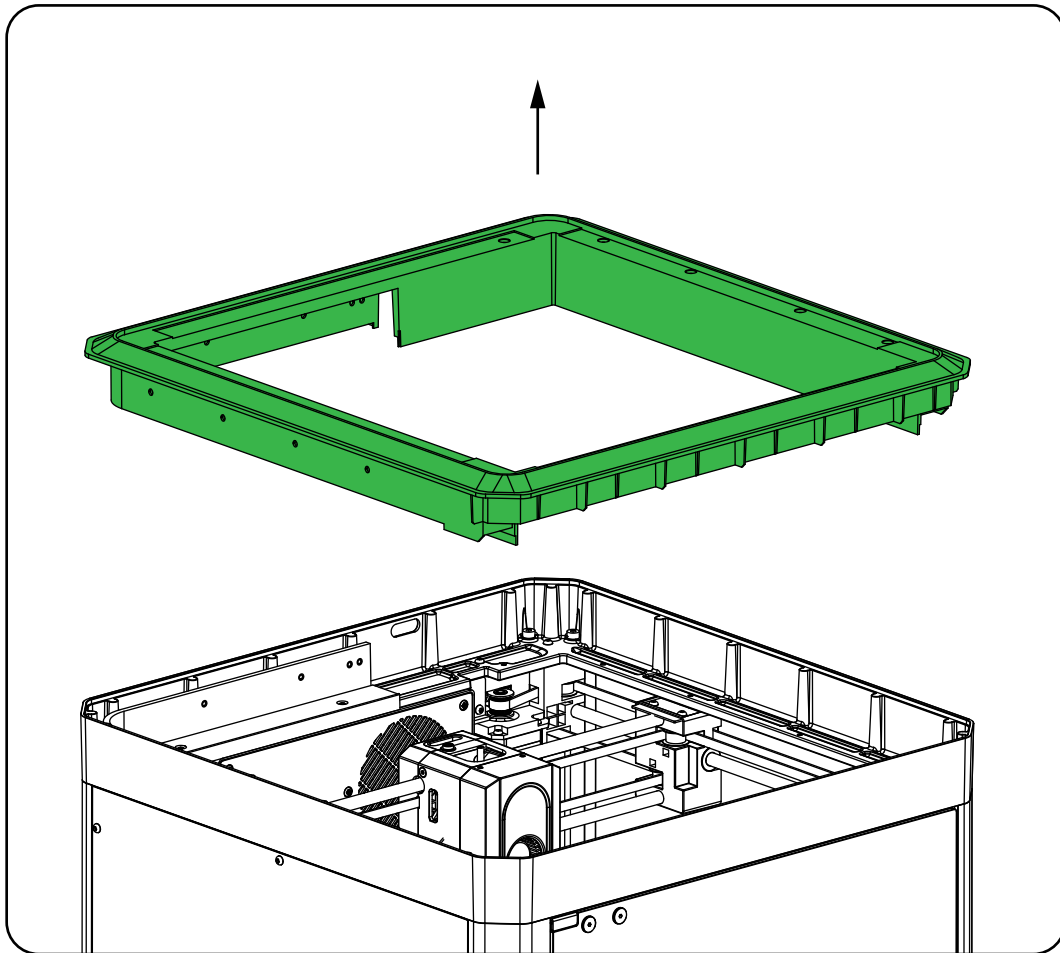

7.Remove the old upper frame plastic shell

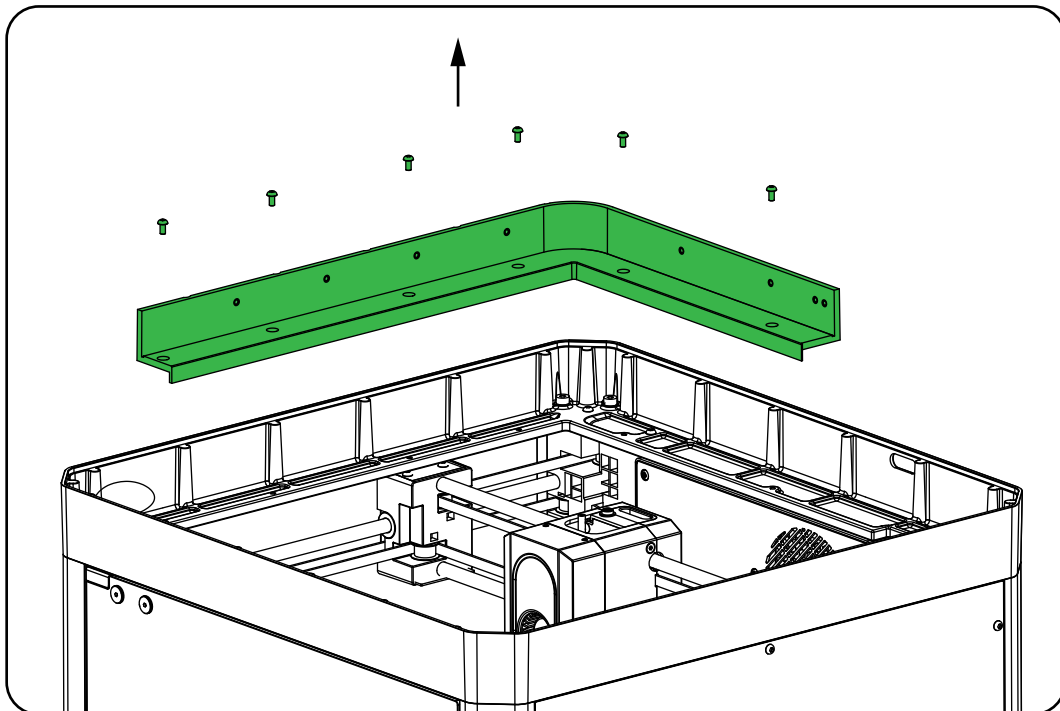

8.Unscrew the six screws (M3 * 6) that secure the old upper frame bottom shell, and then remove the old upper frame bottom shell

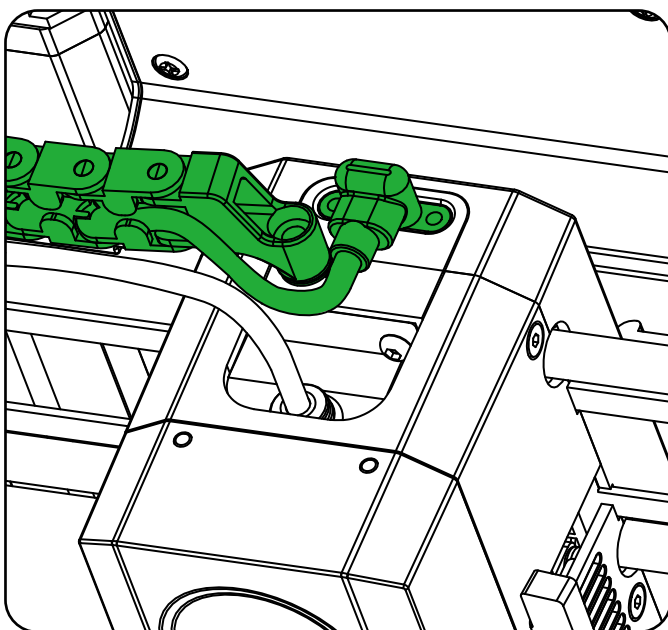
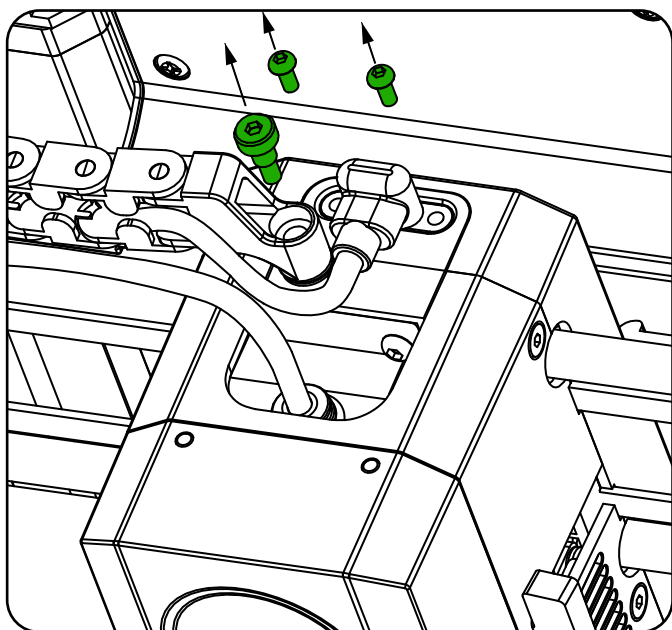

9. Please remove the screws (4 * 4.8 * M3) that secure the drag chain and the screws (M2.5 * 6) that secure the nozzle communication cable first,
Then separate the drag chain and nozzle communication line

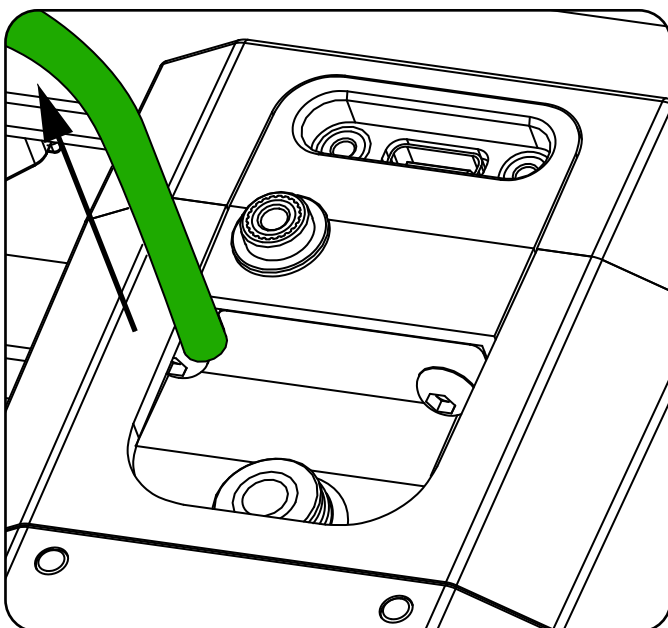
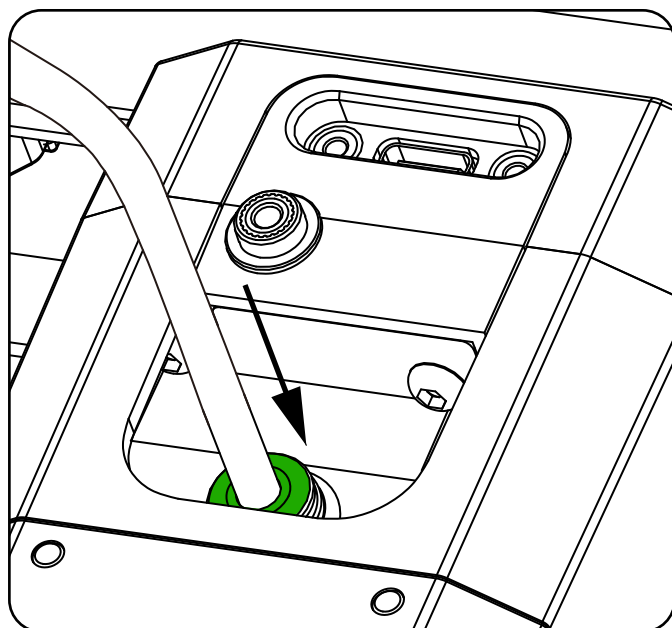

10. Continuously press down on the pneumatic connector tab and pull out the PTFE tube

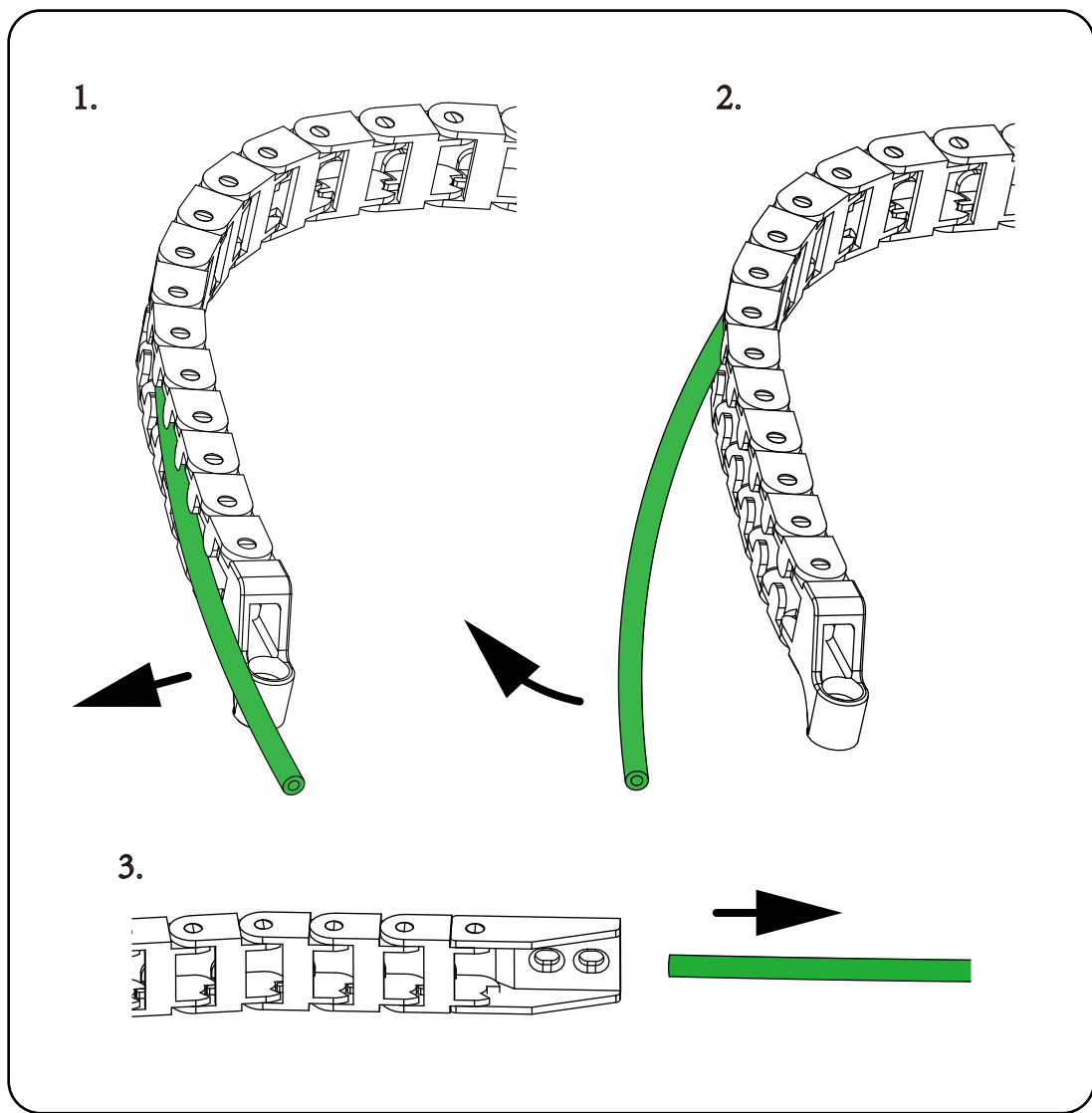

11. Separate the PTFE tube from the drag chain

Drag chain and TYPE-C communication cable

PTFE tube

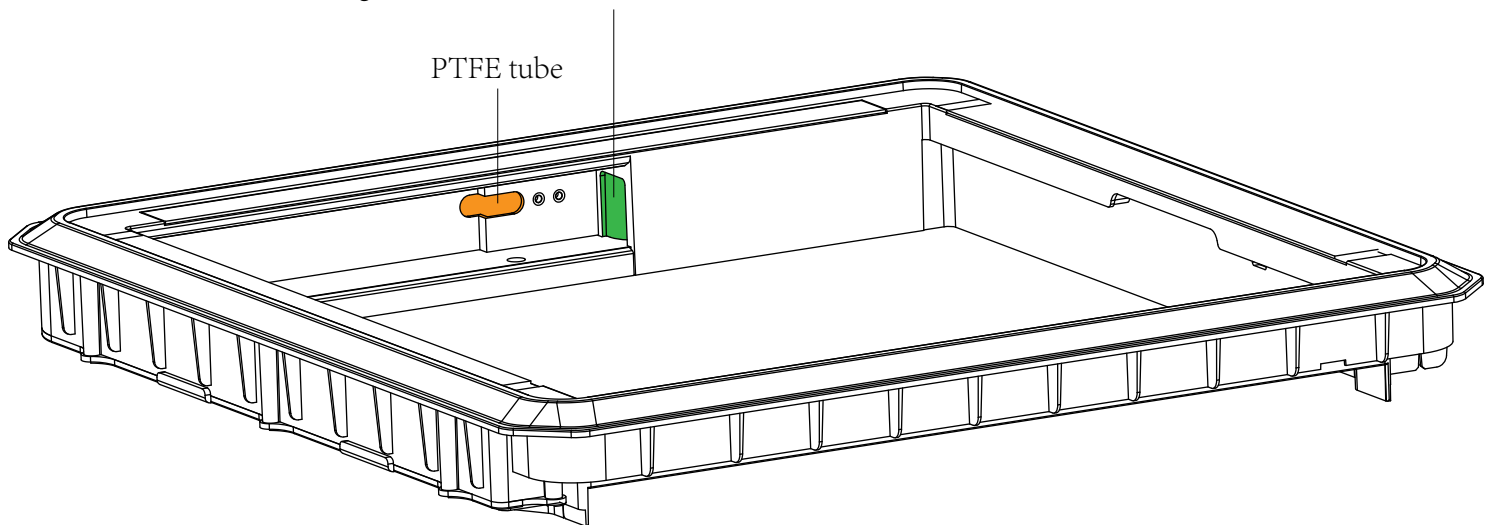

Please pay attention to the two holes on the plastic part of the new frame,
Corresponding to the installation positions of "PTFE tube"
and "drag chain and TYPE-C communication cable" respectively

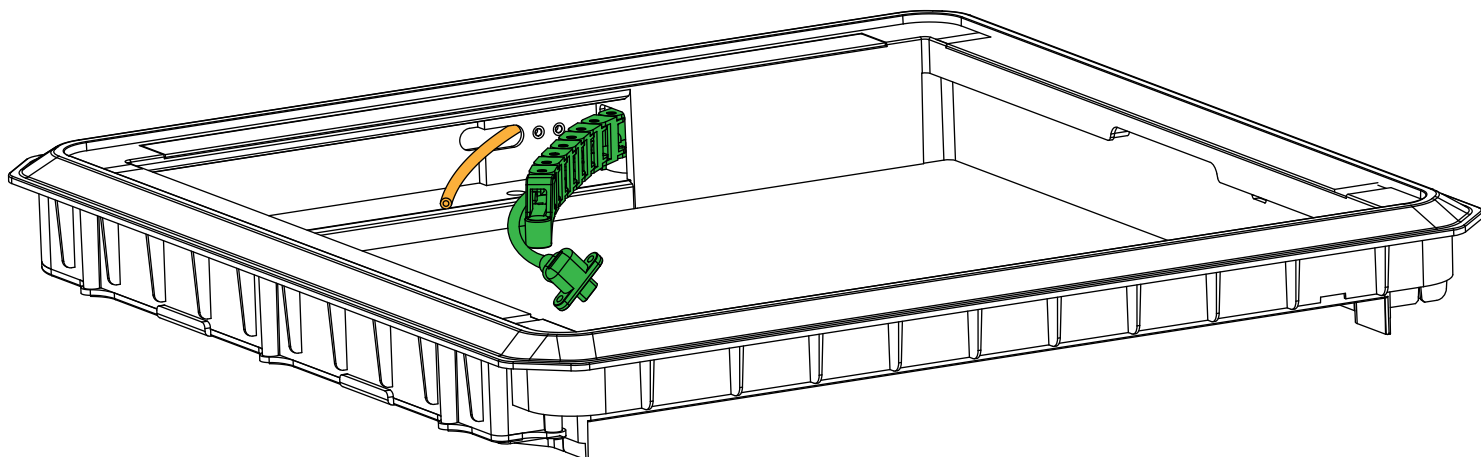

12.First, thread the PTFE tube, drag chain, and TYPE-C communication cable through their respective holes

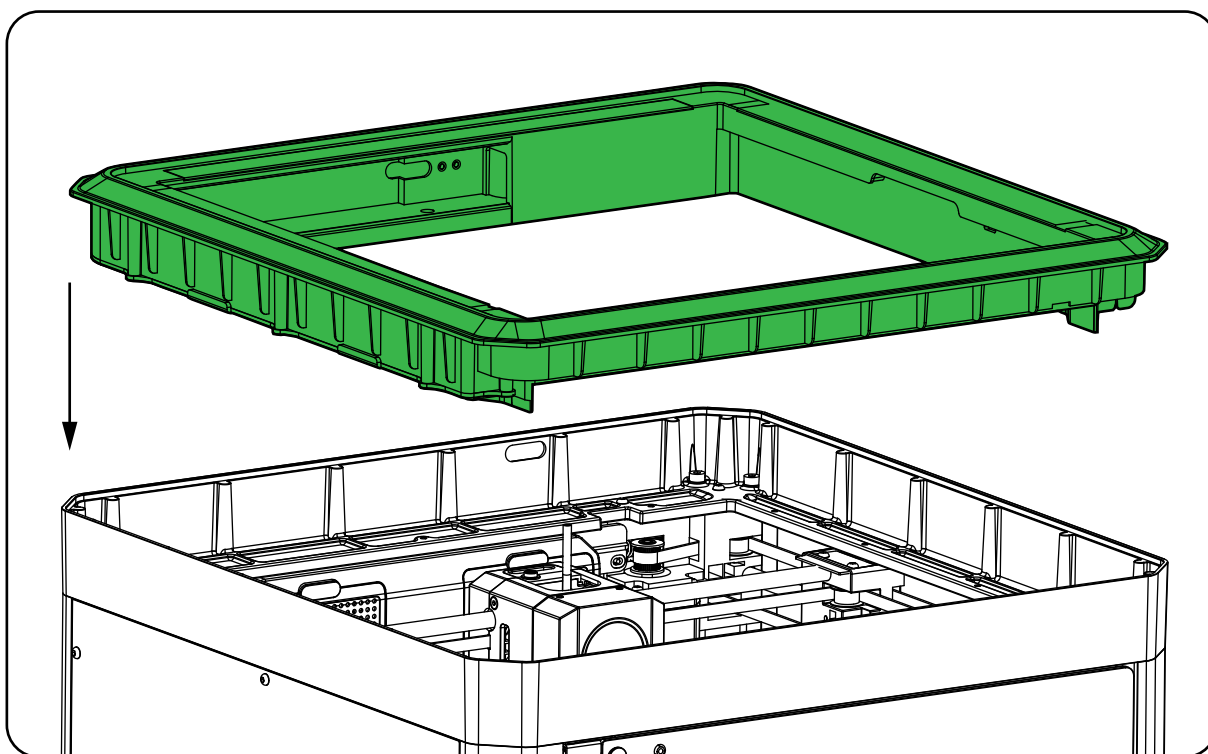

13.Then install it into the machine, please pay attention to sorting out the direction of the extension line of the light strip during the installation process

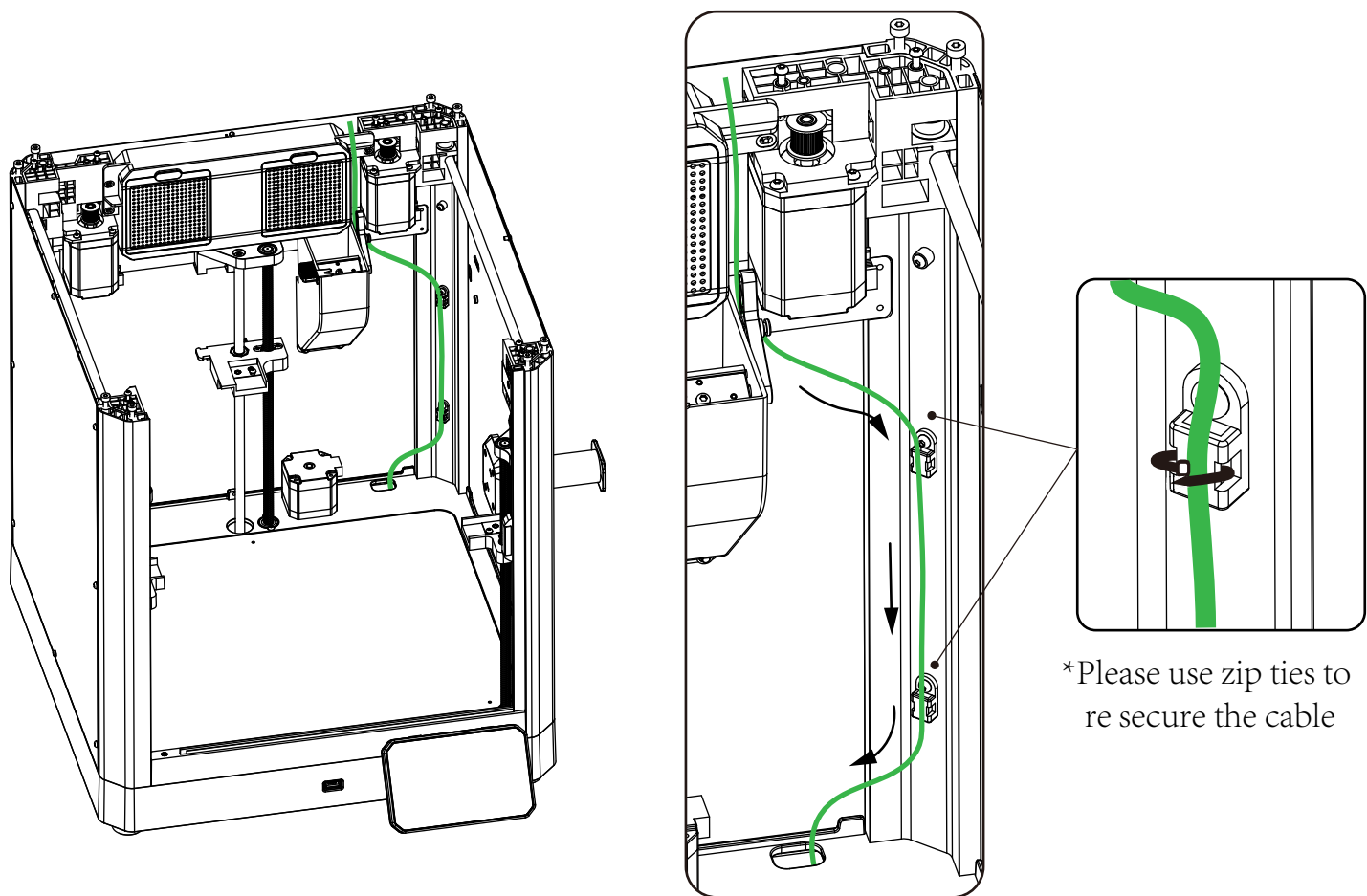

14. As shown in the figure, sort out the direction of the extension cable of the light strip, do not get the wire stuck, and thread the wire into the inlet at the bottom of the box

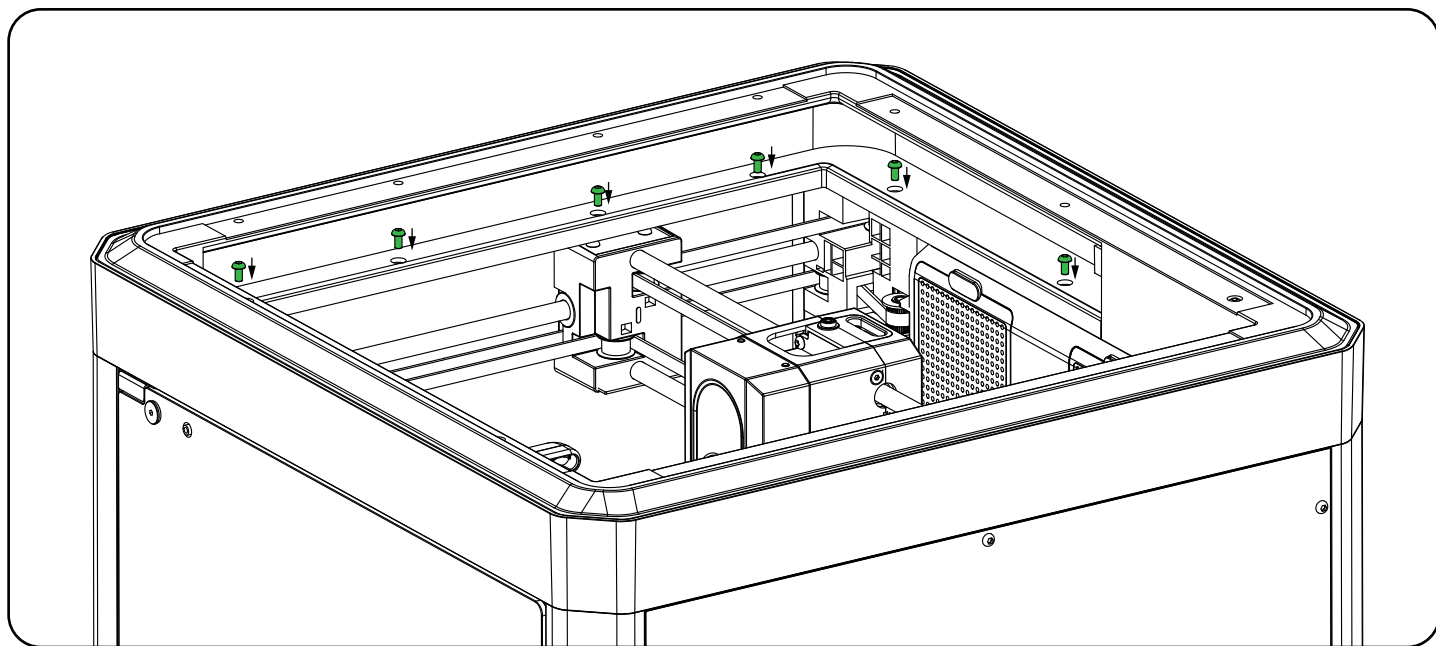

15. Use six screws (M3 * 6) to secure the left and rear parts of the new frame plastic part

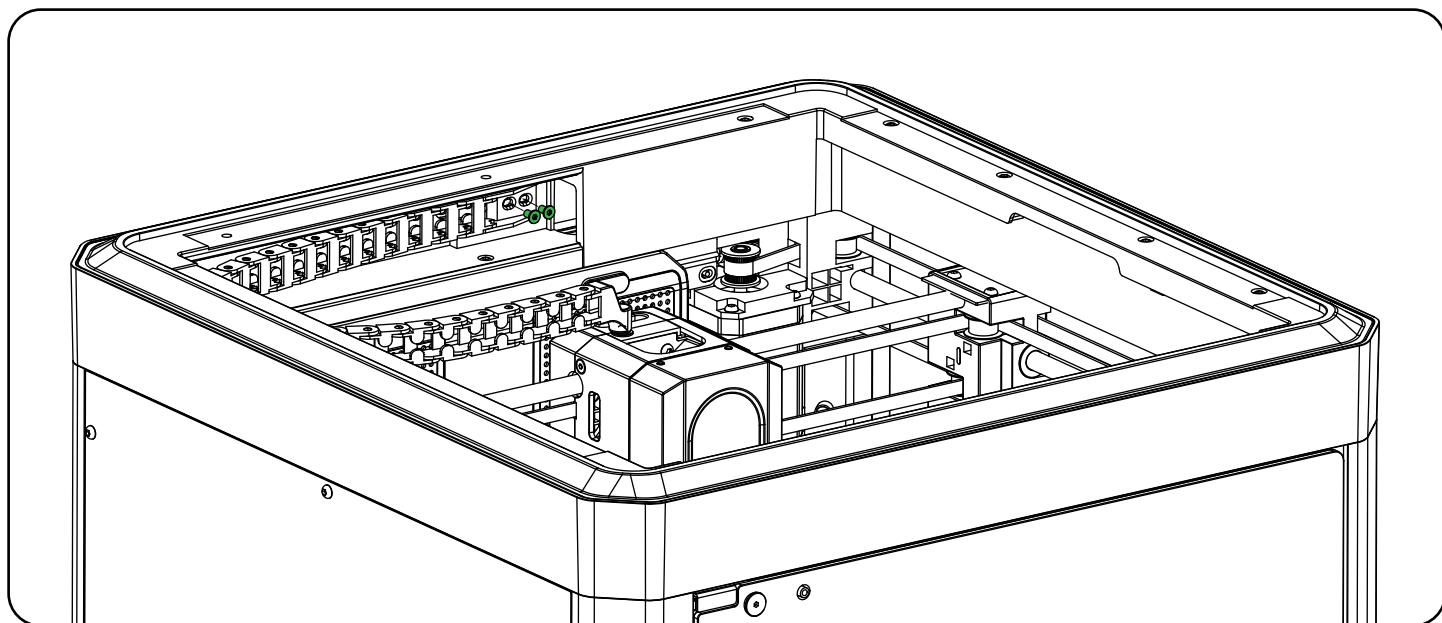

16. Use two screws (countersunk M3 * 6) to secure the rear of the drag chain

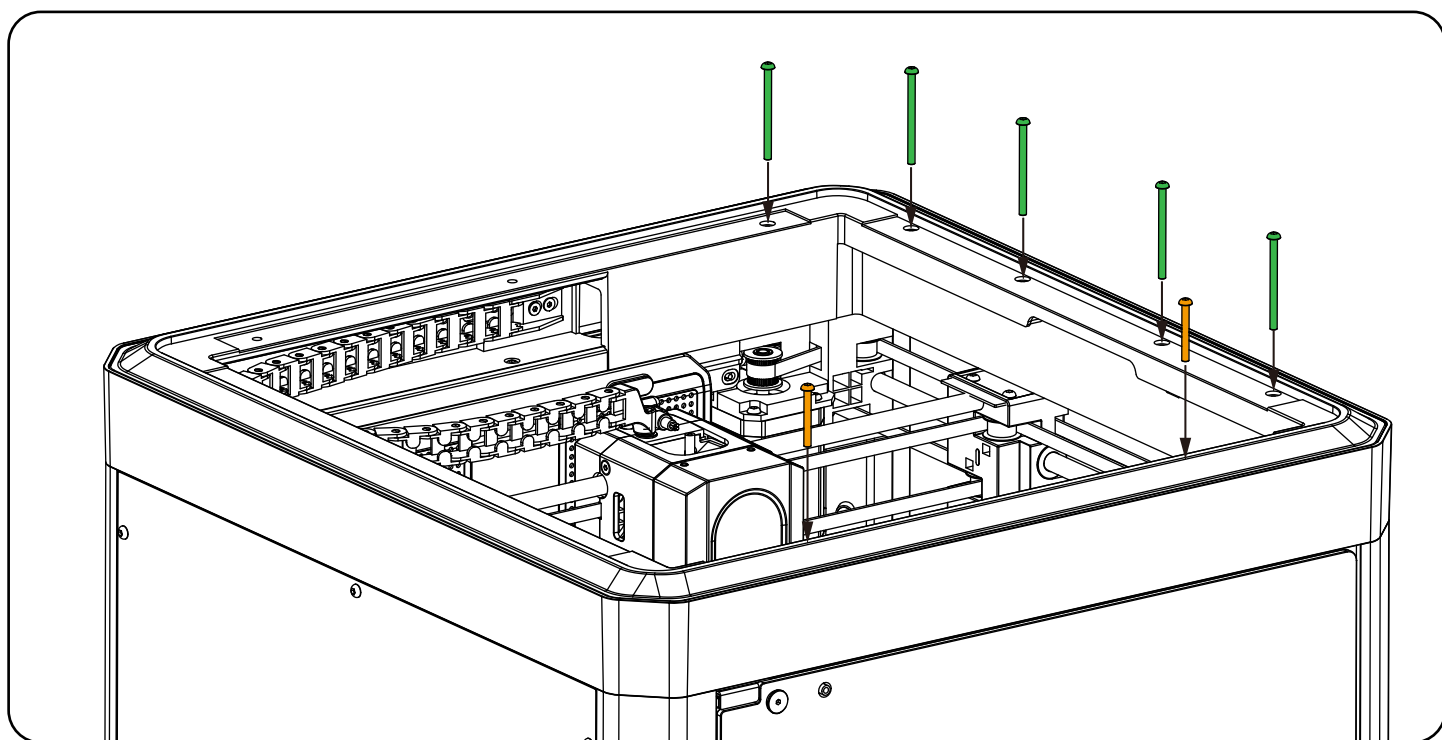

- M3X40
- M3X25

17. Fix the front and right parts of the new frame plastic part

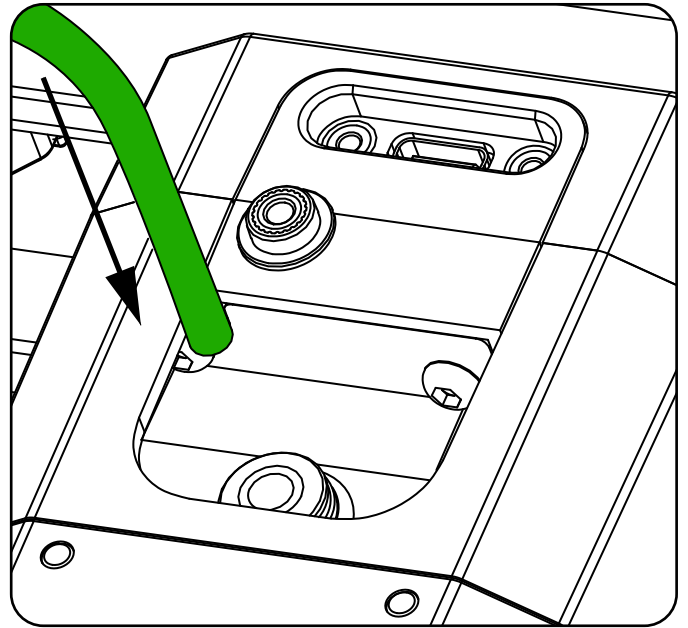
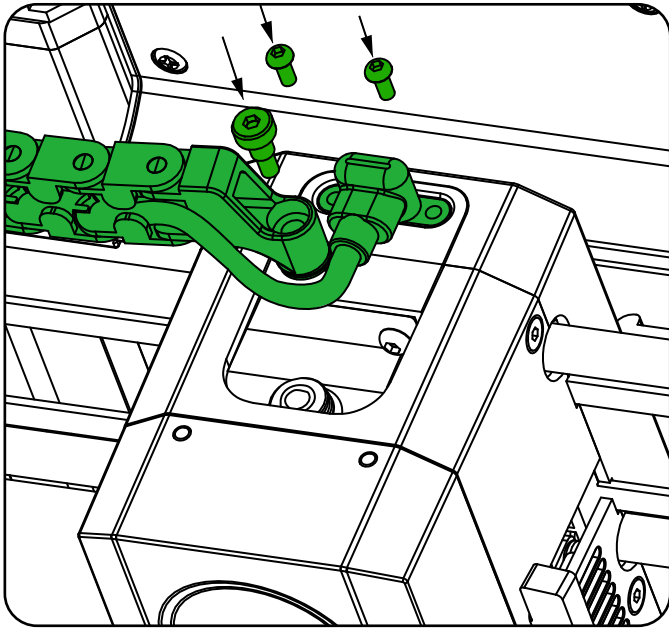

18.Re fix the drag chain (screw 4 * 4.8 * M3) and nozzle communication cable (screw M2.5 * 6) on the extruder,And insert the PTFE tube properly

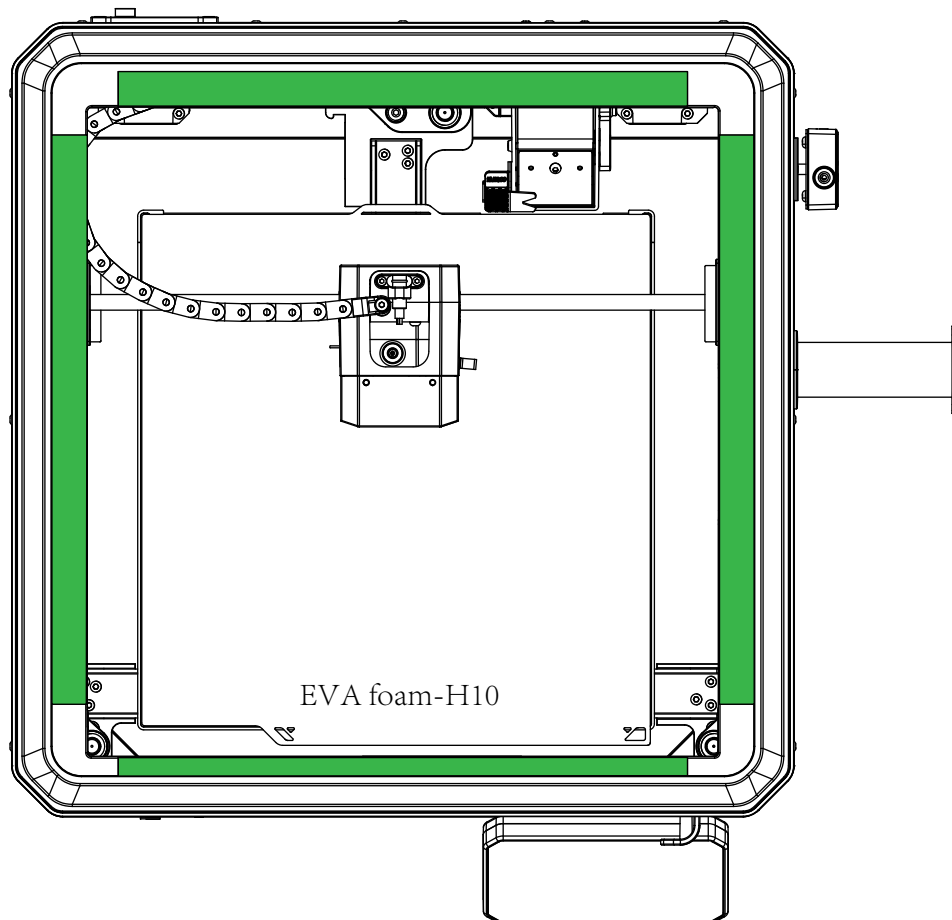

19.Re stick the EVA foam

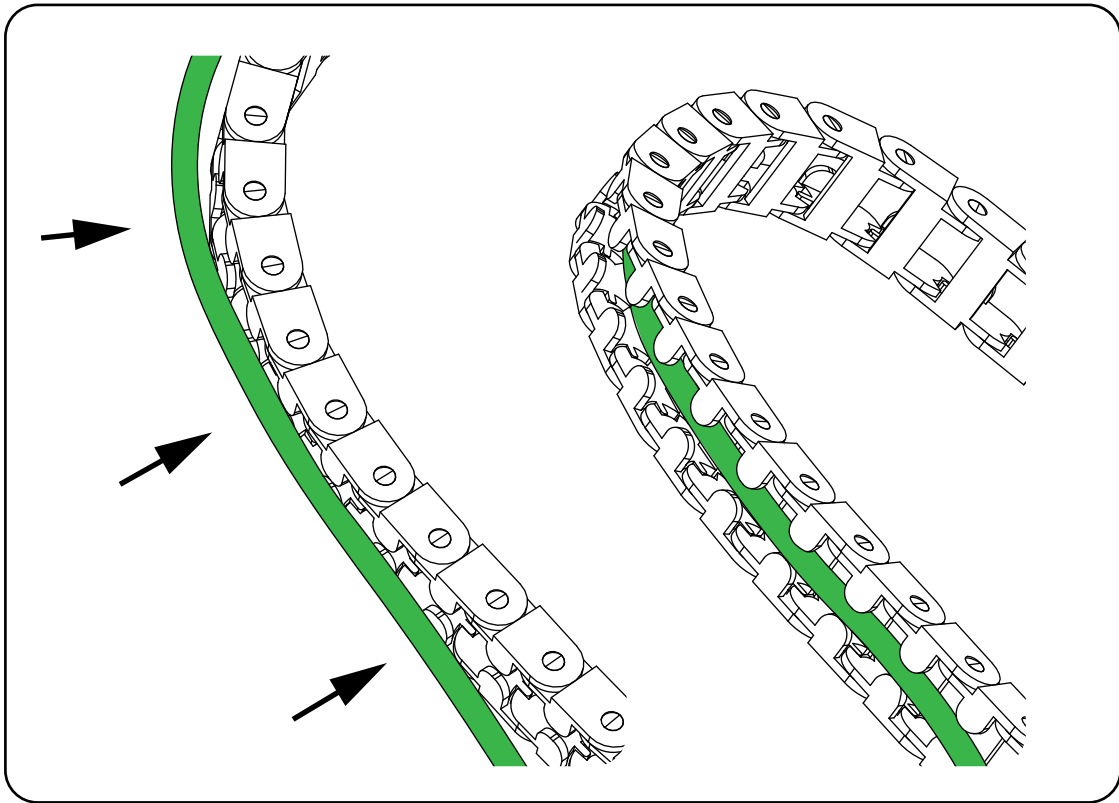

20.If the external PTFE tube is too long or shakes greatly, it can be partially clamped into the drag chain to ensure stability

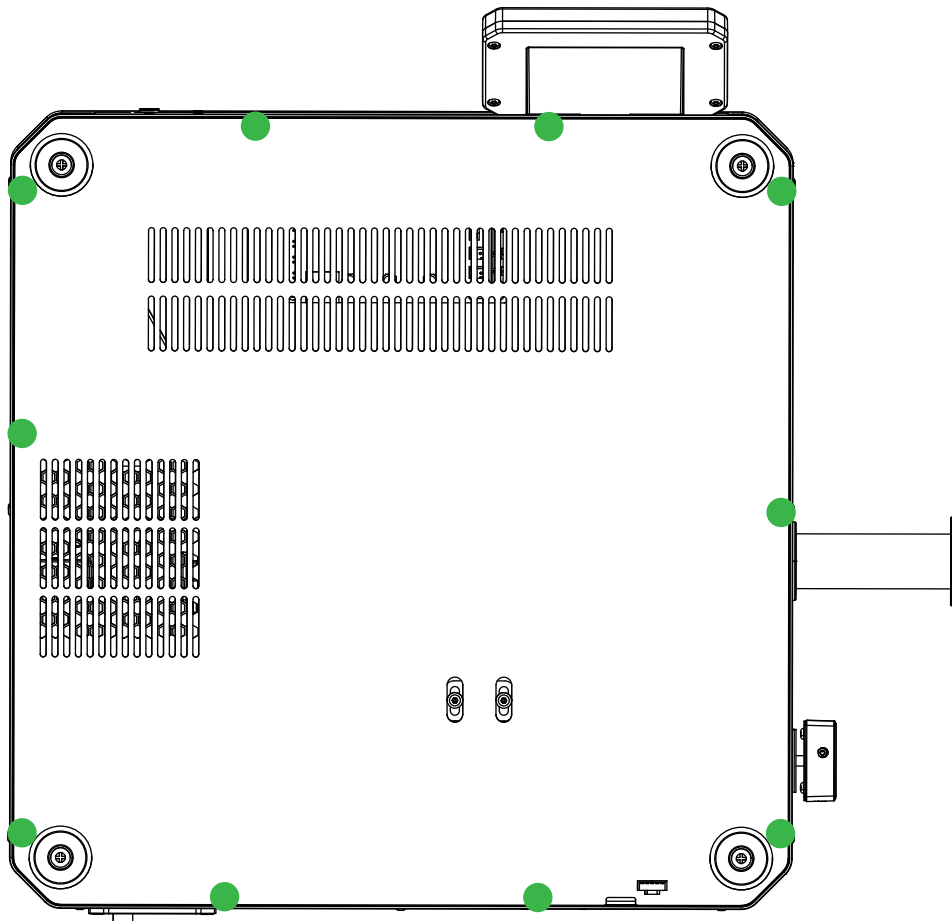

21.Unscrew the ten screws (M3 * 4) that secure the box bottom plate

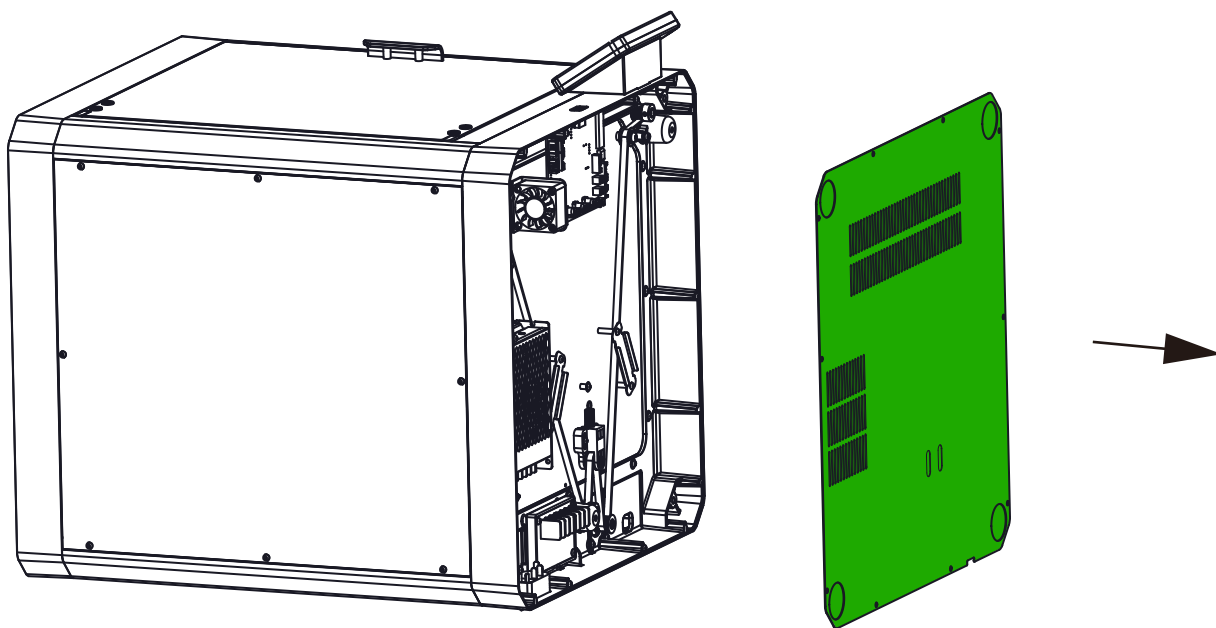

22.Remove the bottom plate

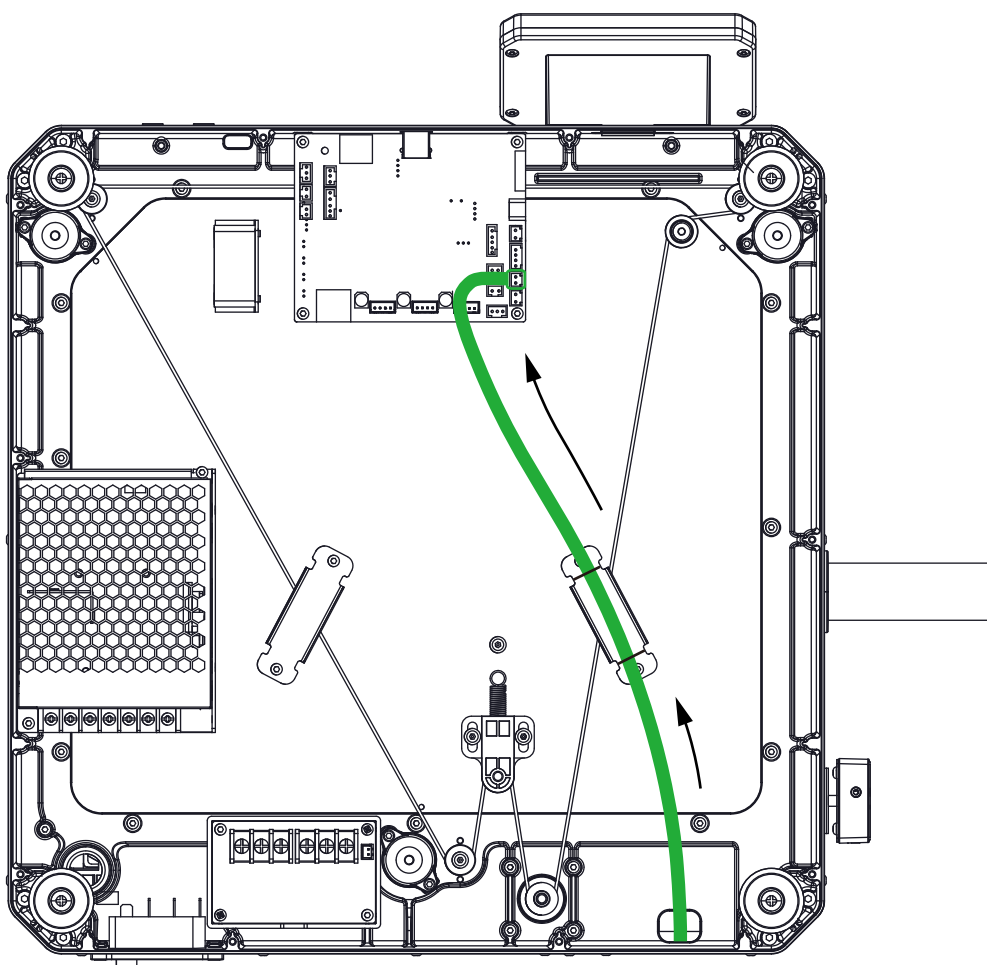

23.Connect the extension cable of the previously inserted light strip to the mainboard

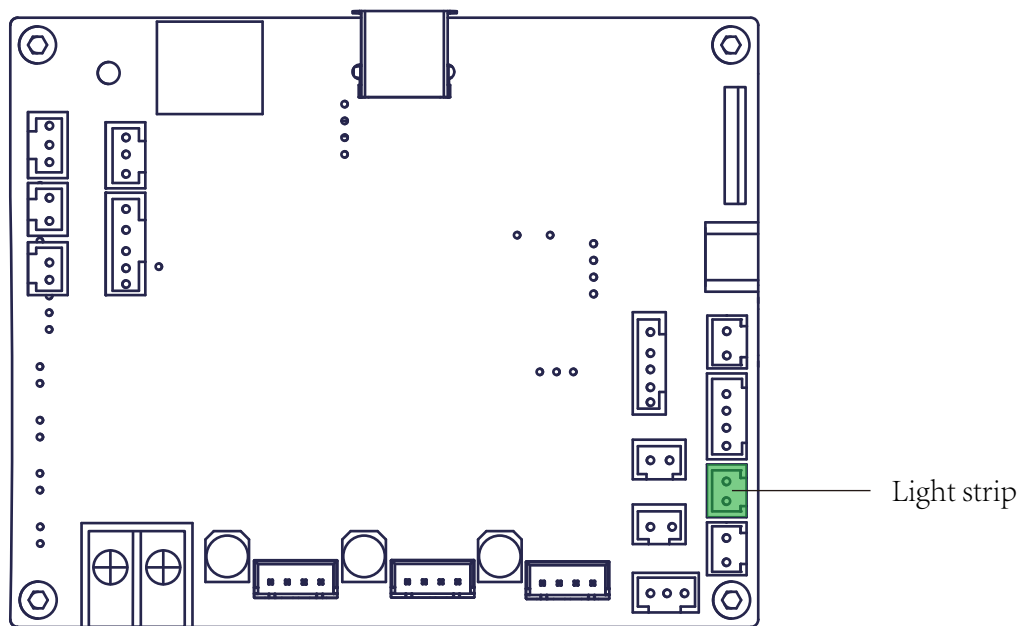

Schematic diagram of mainboard light strip interface

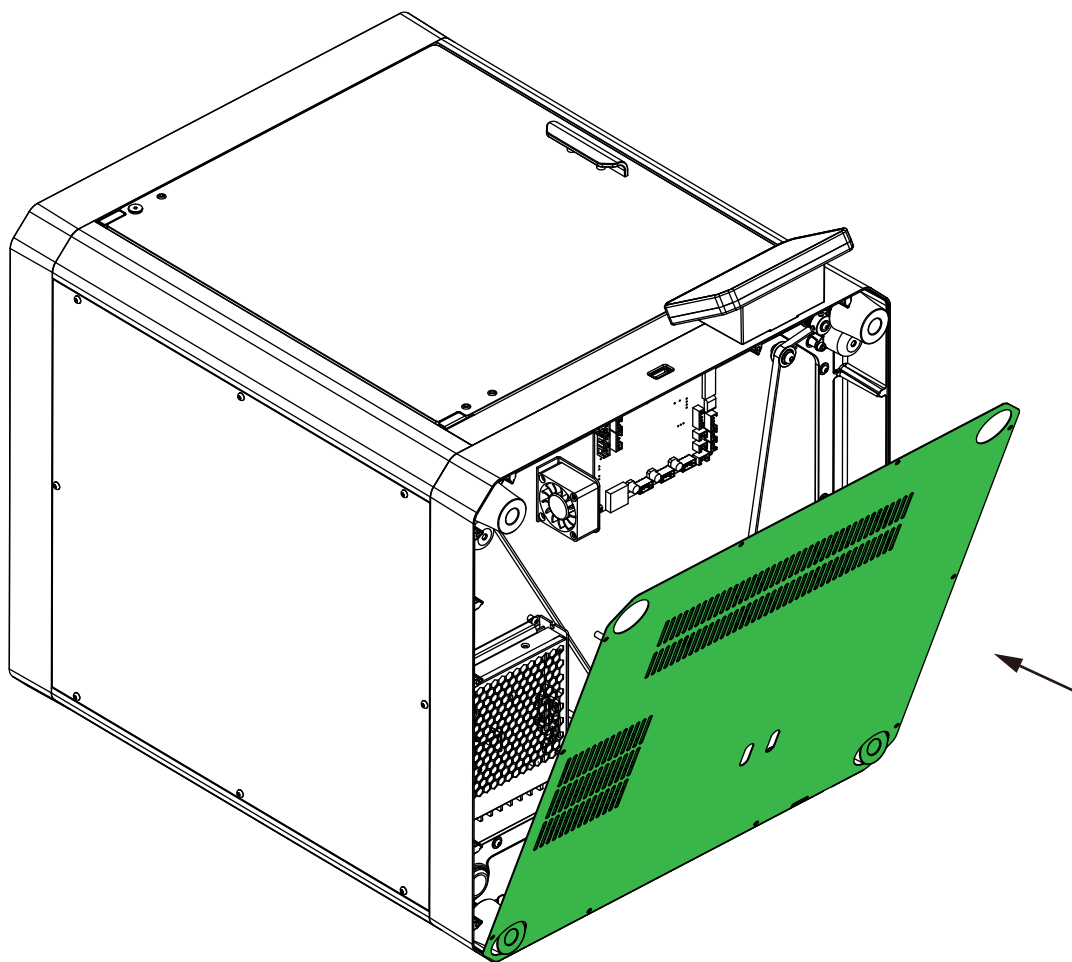

24.Reinstall back the bottom plate,The installation of the new frame plastic shell components has been completed